

HEAVY-DUTY WRECKERS

HDL 700/530 35-Ton Independent Wrecker



TAKING THE INDUSTRY  
TO NEW LENGTHS

HDL 700/530 35-Ton  
Independent Wrecker

Recovering even the heaviest vehicles in the most difficult situations is a cinch when you have extreme versatility and the power to match. Jerr-Dan's HDL 700/530 has the longest underlift reach in its class – a full 142 inches past the tailboard – and a 3-stage independent underlift to give you ultimate flexibility. You will recover vehicles that others simply cannot.

Technology, reliability, versatility and power. You want it. You got it. Because the Jerr-Dan 35-ton independent wrecker delivers it.

Recommended Chassis Requirements

- Minimum GVWR
- Minimum Cab to Tandem / Cab to Drive Tandem (clear)
- Minimum Frame RBM (each rail)
- Minimum Front GAWR
- Minimum Rear GAWR
- Maximum Unloaded Frame Height
- Minimum Frame Length Behind Rearmost Axle

Tandem Axle

64,000 lbs  
165"  
4,200,000 in-lbs  
18,000 lbs  
46,000 lbs  
45"  
40"

Tri Axle

64,000 lbs  
176"  
4,200,000 in-lbs  
18,000 lbs  
46,000 lbs  
45"  
40"

FEATURES



**Underlift Reach**  
181" reach with optional coach underlift.



**Standard Light Pylon**  
Aerodynamic light pylon is standard. Shown here with the upright forward mounted option and the optional LED lightbar, wing mounted lightbars and upper work lights.



**Bus Arms**  
Optional 25,000 lb capacity.



**Tire Lift Organizer**  
Optional Tool Compartment Storage for 14,000 lb or 25,000 lb tire lifts.



**Tilt Cylinder**  
Massive 10" tilt cylinder.



**Drag Winch**  
Optional 35,000 lb drag winch.

Eastern Wrecker Sales, Inc.

SPECIFICATIONS

INDEPENDENT	Distance	Rating
A. Centerline of Rear Tandem to Rear of Tailboard	66"	
B. Reach with Forks, retracted (rear of tailboard to centerline of forks)	72"	53,000 lbs
Reach with Forks, retracted with Optional Coach Underlift (rear of tailboard to centerline of forks)	87"	48,000 lbs
C. Reach with Forks, extended (rear of tailboard to centerline of forks)	142"	17,000 lbs
Reach with Forks, extended with Optional Coach Underlift (rear of tailboard to centerline of forks)	181"	17,600 lbs
D. Maximum Horizontal Towing Height with Fork	38"	
Maximum Horizontal Towing Height with Fork with Optional Coach Underlift	38"	
E. Boom Reach off Rear of Tailboard (boom @ 3.5°)	131"	
F. Boom Working Height to Hook (boom @ 38°)	241"	
G. Maximum Boom Height (boom @ 38°)	273"	
<b>Boom Lift Ratings (SAE J2512)</b>		<b>Rating</b>
Boom Retracted @ 30°		70,000 lbs
Boom Extended @ 30°		22,000 lbs

**Note:** All values are based on a 42" truck frame height and are rounded to the nearest inch.

Values subject to change without notice.

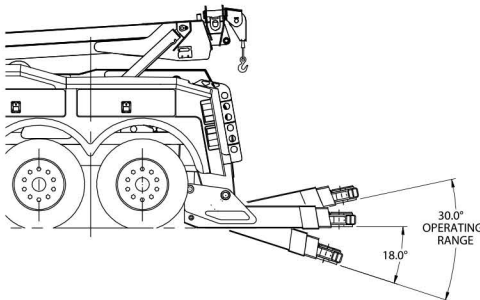
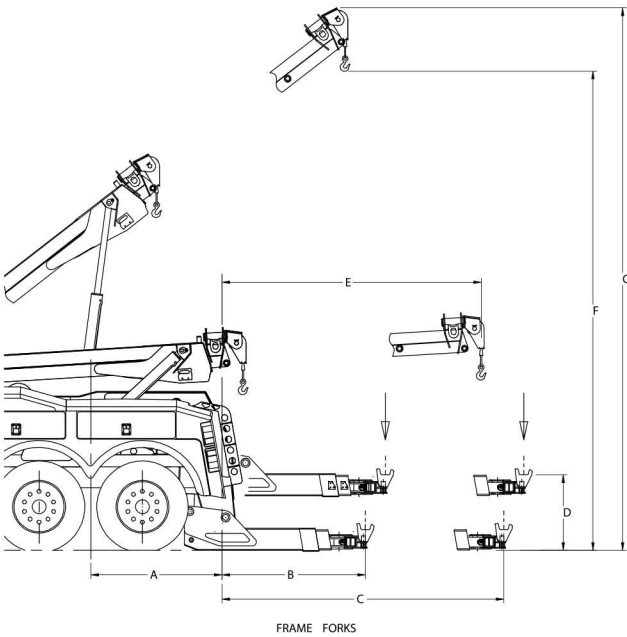

Eastern Wrecker Sales, Inc  
www.easternwrecker.com - 919-553-4038